

Illustrated Index

Refer to the drawing below for the transmission disassembly/reassembly.
Clean all parts thoroughly in solvent and dry with compressed air.

 Lubricate all parts with oil before reassembly.

NOTE: This transmission uses no gaskets between the major housings; use P/N 08718-0001 sealant. Assemble the housings within 20 minutes after applying the sealant and allow it to cure at least 30 minutes after assembly before filling the transmission with oil.

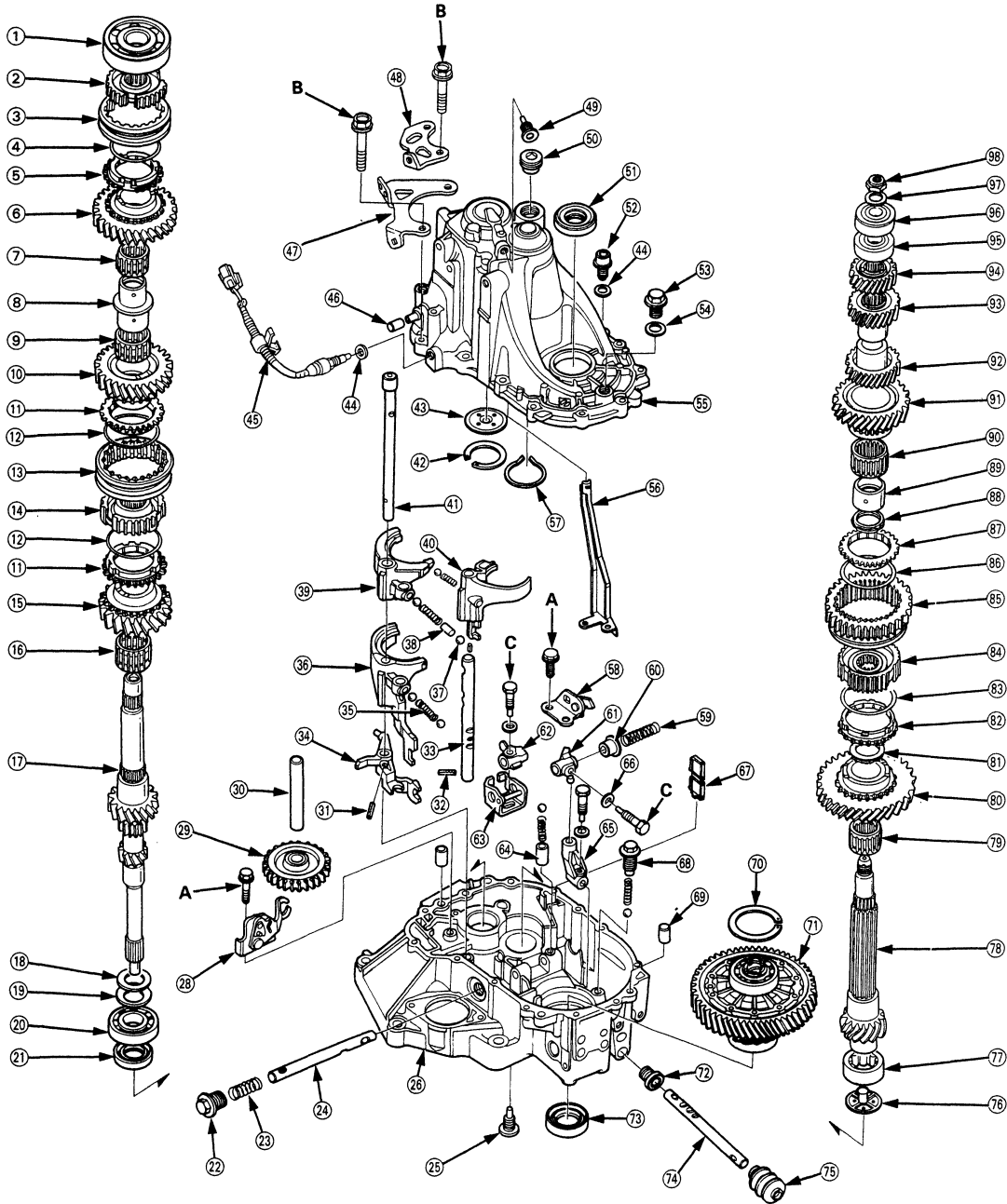



NOTE: Always clean the magnet ⑥7 whenever the transmission housing is disassembled.

Torque Value
A - 15 N·m (1.5 kg-m, 11 lb-ft)
B - 28 N·m (2.8 kg-m, 21 lb-ft)
C - 32 N·m (3.2 kg-m, 23 lb-ft)

- | | | |
|-----------------------------|-----------------------------|-------------------------------|
| ① BALL BEARING | ③⑥ 3RD/4TH SHIFT FORK | ⑥⑨ 14 x 20 mm DOWEL PIN |
| ② 5TH SYNCHRO HUB | ③⑦ STEEL BALL | ⑦⑩ 72 mm THRUST SHIM (*1) |
| ③ 5TH SYNCHRO SLEEVE | ③⑧ 5 x 10 mm ROLLER | 80 mm THRUST SHIM (*2) |
| ④ SYNCHRO SPRING | ③⑨ 5TH SHIFT FORK | Selection, See section 15 |
| ⑤ SYNCHRO RING | ④⑩ 1ST/2ND SHIFT FORK | ⑦① DIFFERENTIAL ASSEMBLY |
| ⑥ 5TH GEAR | ④① 5TH/REVERSE SHIFT FORK | See section 15 |
| ⑦ 32 x 37 x 23.5 mm | SHAFT | ⑦② 14 x 25 x 17.5 mm OIL SEAL |
| NEEDLE BEARING | ④② 65 mm THRUST SHIM (*1) | Replace. |
| ⑧ SPACER COLLAR | 70 mm THRUST SHIM (*2) | ⑦③ 35 x 56 x 8 mm OIL SEAL |
| ⑨ 34 x 39 x 23 mm | Selection, page 13-28 | Replace. |
| NEEDLE BEARING | ④③ OIL GUIDE PLATE | ⑦④ SHIFT ROD |
| ⑩ 4TH GEAR | ④④ WASHER Replace. | ⑦⑤ BOOT |
| ⑪ SYNCHRO RING | ④⑤ BACK-UP LIGHT SWITCH | ⑦⑥ OIL GUIDE PLATE |
| ⑫ SYNCHRO SPRING | 25 N·m (2.5 kg-m, 18 lb-ft) | ⑦⑦ 30 x 47 x 21 mm |
| ⑬ 3RD/4TH SYNCHRO SLEEVE | ④⑥ BREATHER CAP | NEEDLE BEARING (*1) |
| ⑭ 3RD/4TH SYNCHRO HUB | ④⑦ RELEASE PIPE STAY | 30 x 55 x 21 mm |
| ⑮ 3RD GEAR | ④⑧ TRANSMISSION HANGER B | NEEDLE BEARING (*2) |
| ⑯ 34 x 39 x 27.5 mm | ④⑨ 10 mm SEALING BOLT | ⑦⑧ COUNTERSHAFT |
| NEEDLE BEARING | 10 N·m (1.0 kg-m, 8 lb-ft) | ⑦⑨ 36 x 41 x 25.5 mm |
| ⑰ MAINSHAFT | ⑤⑩ 32 mm SEALING BOLT | NEEDLE BEARING |
| ⑱ WASHER | 25 N·m (2.5 kg-m, 18 lb-ft) | ⑧⑩ 1ST GEAR |
| ⑲ SPRING WASHER | ⑤① OIL SEAL | ⑧① FRICTION DAMPER |
| ⑳ BALL BEARING | Replace. | ⑧② SYNCHRO RING |
| ㉑ 26 x 42 x 7 mm OIL SEAL | ⑤② OIL DRAIN PLUG | ⑧③ SYNCHRO SPRING |
| Replace. | 40 N·m (4.0 kg-m, 29 lb-ft) | ⑧④ 1ST/2ND SYNCHRO HUB |
| ㉒ 28 mm PLUG BOLT | ⑤③ OIL FILLER PLUG | ⑧⑤ REVERSE GEAR |
| 55 N·m (5.5 kg-m, 40 lb-ft) | 45N·m (4.5 kg-m, 33 lb-ft) | ⑧⑥ SYNCHRO SPRING |
| ㉓ 1ST/2ND SELECT SPRING | ⑤④ WASHER Replace. | ⑧⑦ SYNCHRO RING |
| ㉔ SHIFT ARM SHAFT | ⑤⑤ TRANSMISSION HOUSING | ⑧⑧ FRICTION DAMPER |
| ㉕ INTERLOCK GUIDE BOLT | ⑤⑥ OIL GUTTER PLATE | ⑧⑨ DISTANCE COLLAR |
| 40 N·m (4.0 kg-m, 29 lb-ft) | ⑤⑦ 52 mm SNAP RING | ⑨⑩ 39 x 44 x 27 mm |
| ②⑥ CLUTCH HOUSING | ⑤⑧ REVERSE LOCK CAM | NEEDLE BEARING |
| ②⑧ REVERSE SHIFT HOLDER | ⑤⑨ REVERSE SELECT SPRING | ⑨① 2ND GEAR |
| ②⑨ REVERSE IDLER GEAR | ⑥⑩ REVERSE SELECT RETAINER | ⑨② 3RD GEAR |
| ③⑩ REVERSE IDLER GEAR SHAFT | ⑥① SHIFT ARM C | ⑨③ 4TH GEAR |
| ③① 5 x 22 mm SPRING PIN | ⑥② SHIFT ARM B | ⑨④ 5TH GEAR |
| Replace. | ⑥③ INTERLOCK | ⑨⑤ BALL BEARING (*1) |
| ③② 3 x 12 mm SPRING PIN | ⑥④ COLLAR | NEEDLE BEARING (*2) |
| Replace. | ⑥⑤ SHIFT ARM A | ⑨⑥ BALL BEARING |
| ③③ 1ST/2ND SHIFT FORK SHAFT | ⑥⑥ SPRING WASHER | ⑨⑦ SPRING WASHER |
| ③④ 5TH/REVERSE SHIFT PIECE | ⑥⑦ MAGNET | ⑨⑧ LOCKNUT |
| ③⑤ SPRING | ⑥⑧ SET BALL SPRING BOLT | 110-0-110 N·m |
| | 22 N·m (2.2 kg-m, 16 lb-ft) | 11.0-0-11.0 kg-m, |
| | | 80-0-80 lb-ft |

*1: D15B8, D15B7, D15Z1

*2: D16Z6